



Hide Your IP with IP Viper Software

Installation Guide & User Manual Version 1.0

Prior to installing the IP Viper software, please read the following instructions to ensure you set up the program correctly for optimal performance.

The System requirements:

Minimum Requirements:

Internet Connection*: Broadband

Operating System: Vista, or Windows 7, 8, 8.1, 10, 11

Computer Processor:

CPU with SSE2 support, including Intel Pentium 4, Pentium M, Core or Atom, AMD Athlon 64 or later.

Computer Memory: 512 MB or better

Screen Resolution: 1024x768 pixels



Software Installation

To install the software on your computer please follow these simple instructions :

1. Download the software & unzip the folder to extract the contents, including the program and associated components.
2. Open the PROGRAM folder by double clicking to show the program files.
3. If you wish to create a shortcut to your desktop (recommended) , right click the **IP Viper software file** and select **send to desktop (create shortcut)**.
4. **This will place an icon on your desktop for quick access and save you navigating to the original folder when you want to run the program. The software can be opened from the desktop from now on.**
5. The software is now ready to run for the first time. Double click the IP Viper icon and the app will open and ask you to either select the 3 day trial or enter your licence key purchased. Click enter licence key and input a valid key.
6. The software will now open. See the quick start guide below to configure settings for optimal use.

Quick start guide

1. Open the software.
2. Click on the **IP Viper main settings** tab and select **“Add Your Own Sites”**
3. As not all proxies work well with all websites , its important to select the websites you are interested in surfing & input these in the **Add Your Own sites**. Delete any sites you are not interested in and this will increase the speed of the scan time.

Only enter a maximum of 10 sites at any time.

4. If you have previously scanned then any active IP addresses will be held in memory and can be viewed from the table.
5. Alternatively, press the **“CLICK FOR PROXIES”** button & wait for the scan to complete.
6. You can terminate the scan at any stage if you feel you have enough IP addresses displayed
7. Filter results by whatever method you require, ie speed/website etc.
8. Select an IP address from the list and click the **“Use fake IP”**.
9. If you want to try a different IP , again simply click on an IP from the table and click **“Use fake IP** to change to another IP.

Quick start (Continued)

10.To return to your real IP just click **“Use real IP “**

11.You can save any favourite IP addresses for next time by clicking on the save column of the corresponding IP address.

12.You can check these have been saved by clicking on the **Stored IP'S** on the interface.

IMPORTANT- Its essential to keep the program open when surfing with a fake IP and also to ensure you return to your real IP BEFORE closing the application. Otherwise, you may have a connection issue when trying to reopen the software as the licence check will not be verified if the last IP (FAKE IP) has been left on your network settings due to not returning to your own IP. To avoid this, please ensure you click **“USE REAL IP” BEFORE** closing the software.

* BROWSER SETTINGS (First time use only).

Firefox users who use the software for the first time will need to set their browsers settings to the **“Use system proxy”** settings when they use the software for the first time.Then you can use it as above thereafter with no further browser setting adjustments required.The setings for Firefox are follows :

Options > Advanced tab> Network> Settings >Use system proxy settings > OK

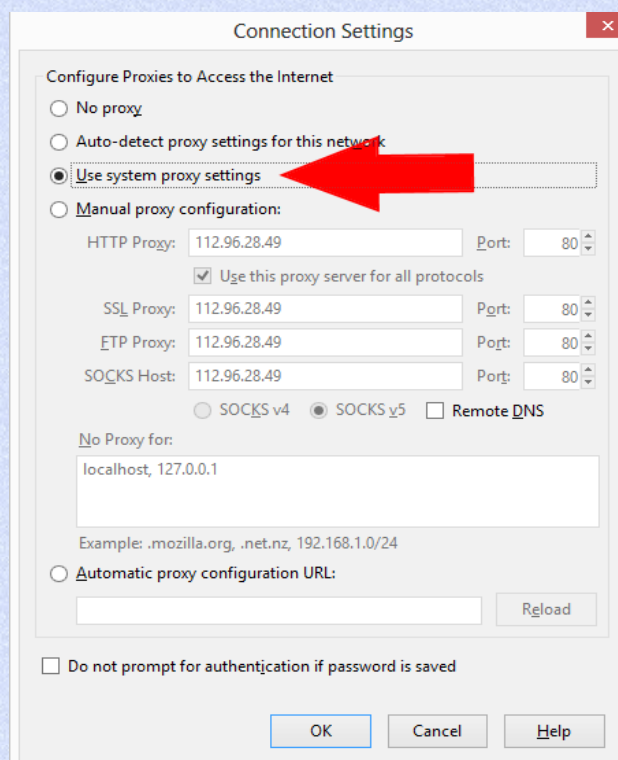

IE and Chrome users require no initial setting changes and can use the software as is.

*** IMPORTANT**

Depending on what version of windows you are running, its vital to ensure your network/internet settings for proxies are turned to “Automatically detect settings”. This will ensure that any tracking or analytics software will record your visits from the proxy you have selected, rather than your own IP address. If running windows 11, you can do this from the image below, with the path:

Network & Internet > Proxy > Automatically detect settings

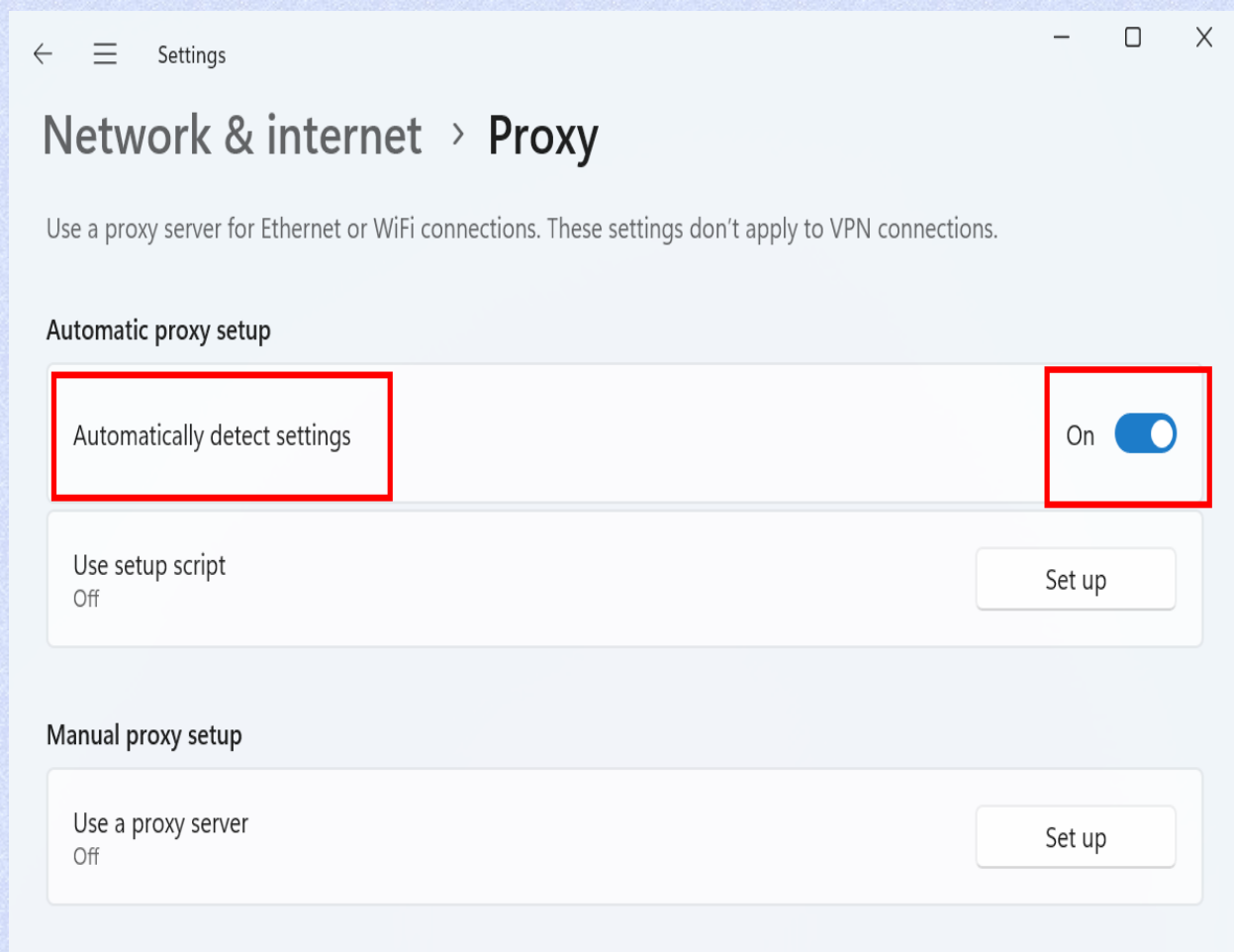

You will need to do this in addition to the above browser settings if using Firebox as your default browser.



Some FAQ's

Is the software for windows or MAC?

Windows only and works on all versions from W7-W11.No MAC version is available at present.

How much is it each month?

There is no subscriptions, just a one time payment for lifetime use!

Can you tell me a little about the software?

IP Viper is easy to set up and will scour the internet to find numerous proxies and test each individually to check performance against the default websites within the software(you can add your own websites also).Working proxies are then shown within the display table .The software will check the best proxies for that chosen site for best connection as all proxies perform differently with different websites.You can then choose a proxy to hide behind. You can learn more about the features of the software from www.ipviper.com

What browsers work best with IP Viper?

Most popular browsers like Firefox, Chrome & Edge. We recommend Firefox.



Are all the proxies found anonymous proxies ?

The software will try to ensure only the most anonymous proxies are found and shown in the active display table, though it should be remembered that whilst the proxy judge being used to identify the privacy level of the said proxy is generally reliable , it is not 100% full proof. Therefore it is recommended to test the chosen proxy first to check its anonymity level.

Is IP Viper difficult to set up & use?

No, in fact its very easy from start to finish. Even a novice can have it up and running in minutes!

Can I use my own proxies I have at my disposal ?

Yes, of course. There is a place within the software to manage your own proxies

Can I install IP Viper on more than 1 computer ?

No, its 1 license key per device, though we can transfer your license to another new device if and

when required.



Should I use IP Viper for secure transactions like banking?

No, because the software finds and uses public proxies, these proxies should not be trusted for sensitive information like banking transactions. It is perfect for recreational use where sensitive data transactions are not critical*

How can I find my own IP address?

The software will display this for you when the application is opened.

What should I do if I see a connection error when trying to open the software?

Check to make sure your antivirus program and firewall are not blocking the app from connecting to the internet. Alternatively, you can contact us at support@ipviper.com.

- *The software use proxies/ip's available to the public and is intended for recreational use to help with maintaining a degree of online privacy and as such the authors of the software will NOT be held liable for ANY loss through use or misuse of the software.*

The end user will accept that any use, or misuse, of such proxies is solely the responsibility of the end user and the authors of IP Viper will not be held liable for any such use, whether this be for legitimate use or illegitimate use of the software. As such publicly available ips cannot be verified as being entirely secure or able to encrypt all data being transmitted, under no circumstances should the end user use such proxies for secure online activities such as banking, financial transactions, use of passwords or any authentication requirements, or any data transmission that is regarded as being critical or sensitive or requiring secure encryption..

We hope you enjoy using your software & hiding your real IP !

IP Viper 2023

